

KEY

- Cone
- Sign
- Closed area
- Diversion route
- Pedestrian route
- Pedestrian ramp (Fixed to ground)
- Pedestrian Barrier

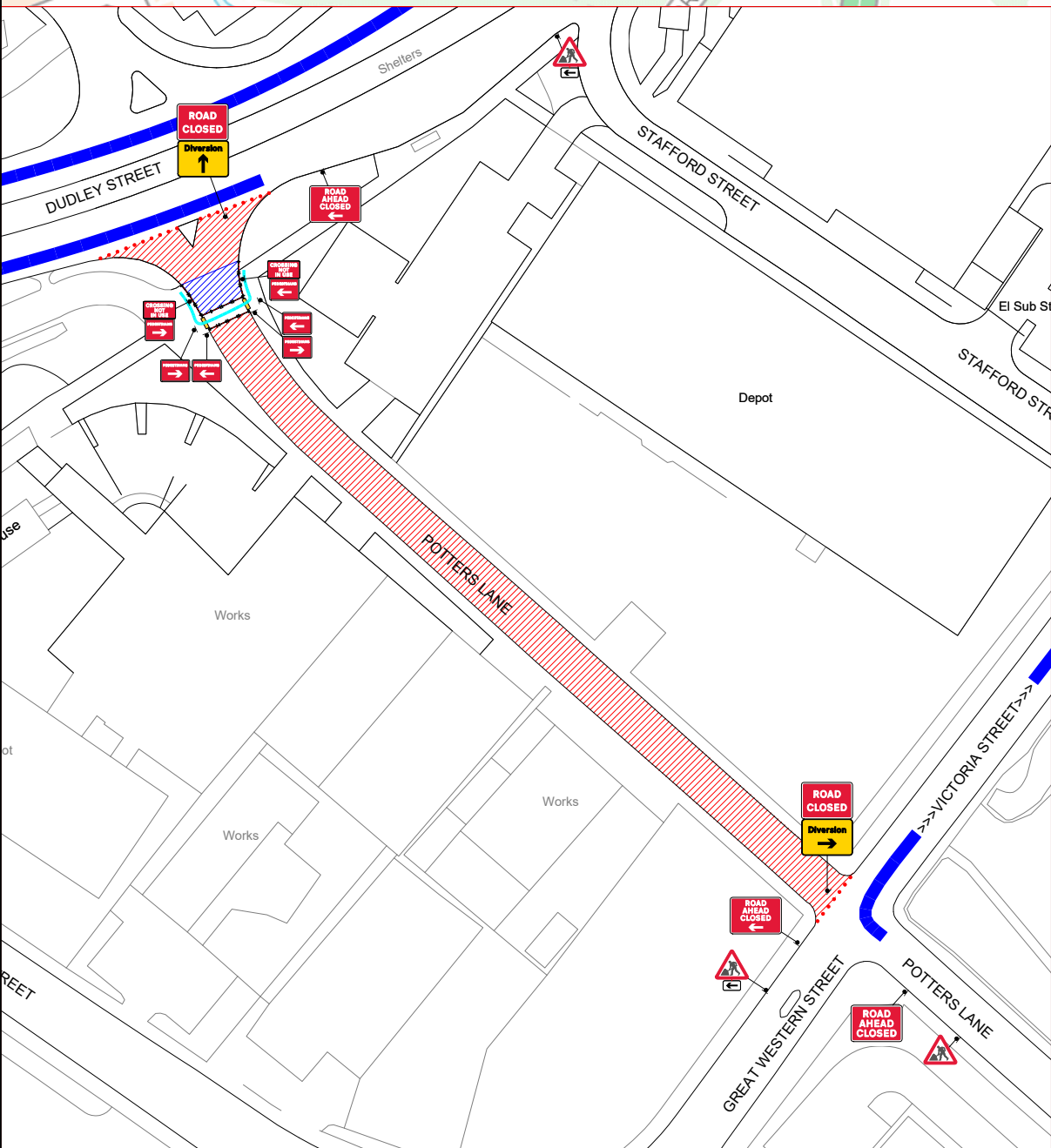

What3words ///skip.shed.insect



KIT LIST

Qty: 3 Ref: 13.9 FOOTWAY CLOSED	
Qty: 1 Ref: 13.9 TEMPORARY BUS STOP	
Qty: 1 Ref: 13.9 BUS STOP SUSPENDED	
Qty: 1 Ref: 517 Road narrows on one side only ahead - left	
Qty: 2 Ref: 573 Direction to hazard right	
Qty: 3 Ref: 610 Keep left	
Qty: 7 Ref: 610 Keep right	
Qty: 7 Ref: 645 End panel	
Qty: 13 Ref: 7001 Road works ahead	
Qty: 2 Ref: 7018 Pedestrian diversion Right	
Qty: 2 Ref: 7018 Pedestrian diversion Left	
Qty: 2 Ref: 7105 Lane closure barrier	
Qty: 5 Ref: 7202.1 Temporary lane availability	

Rev	Description	By	Chkd	Date

Revisions

Client
nationalgrid

Project
Potters Lane,
Wednesbury, WS10 7LE
Grid Ref: 398272 , 294770

Title
Road closure
and diversion

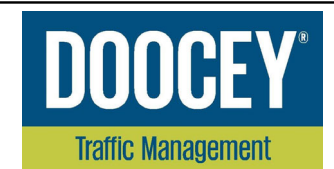

Design: HJS	Drawn: HJS	Chkd: AW
Date: 04/03/26	Date: 04/03/26	Date: 04/03/26
Scale: NTS @ A3	Status:	
Drawing No 49326.003		Rev: