

Qty: 1 Ref: 13-9-YAR Direction to hazard Right	
Qty: 1 Ref: 13-9 Schedule 13-9 - Temporary Information	
Qty: 1 Ref: 13-9 Schedule 13-9 - Temporary Information	
Qty: 1 Ref: 572 Distance ahead to hazard	
Qty: 3 Ref: 573 Direction to hazard right	
Qty: 1 Ref: 573 Direction to hazard left	
Qty: 2 Ref: 610 Keep right	
Qty: 1 Ref: 645 End panel	
Qty: 6 Ref: 701 Road works ahead	
Qty: 2 Ref: 7105 Lane closure barrier	
Qty: 1 Ref: 7202.1 Temporary lane availability	
Qty: 1 Ref: 7202.1 Temporary lane availability	
Qty: 1 Ref: 7202.1 Temporary lane availability	

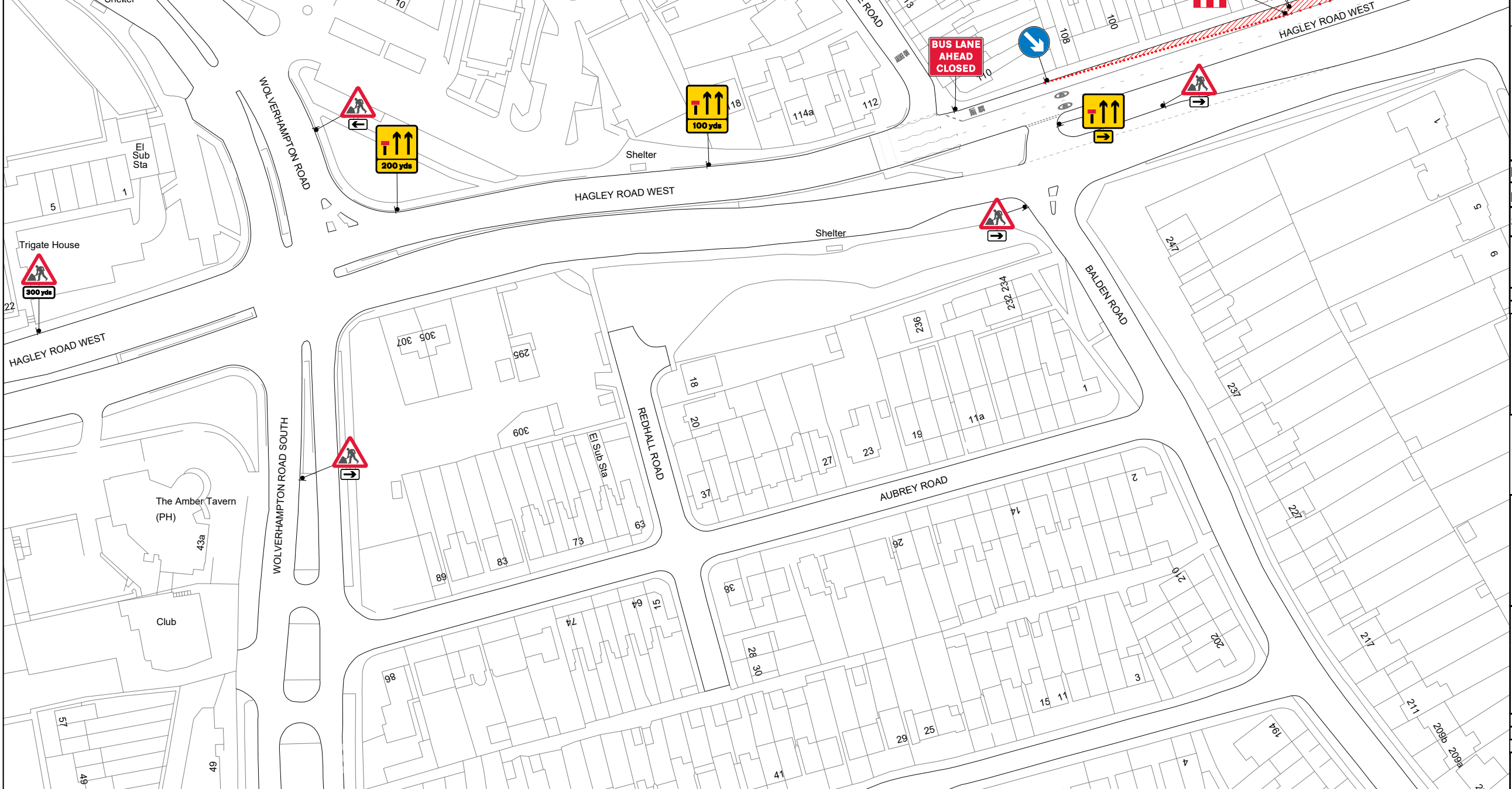

KEY

- Cone
- Sign
- Work area
- Closed area
- Traffic light head
- Traffic light phase

DETAIL B

.....

Single/Dual carriageway 40mph or less - 450mm traffic cones, spacing 1.5m.
Single/Dual carriageway 50mph or more - 750mm traffic cones, spacing 1.5m.
Dual carriageway national speed limit - 750mm traffic cones, spacing 1.5m, relaxation 3m.

Notes:

- 1) During darkness, warning lights to BS EN 12352:2006 should be provided in accordance with Table A1.3 (Appendix 1).
- 2) 45 degree tapers have 1.5m spacing and no relaxations.
- 3) On motorways and NSL AP duals with hard shoulders, 1m cones will be required for both standard and relaxation works for lead tapers and the facing wall of lane changes.

DETAIL C2

.....

Single carriageway 40mph or less - 450mm traffic cones.
Single/Dual carriageway 50mph or more - 750mm traffic cones.

Notes:

- 1) During darkness, warning lights to BS EN 12352:2006 should be provided in accordance with Table A1.3.

Lane 1 Closure or Shuttle Lane

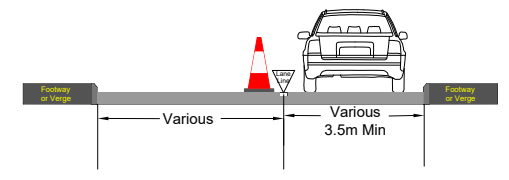

Min width of sideways safety zone (S)	0.5 m
Min length of longways clearance (L)	15 m
Speed of the road	

Rev	Description	By	Chk	Date
Revisions				

Client:

Project:
Hagley Road West, Smethwick,
B67 5EY
Grid Ref: (x)401469 ; (y)285416

Title:
Temporary Lane Closure

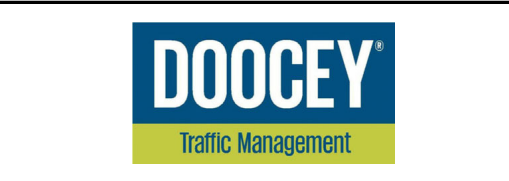

Design: AW	Drawn: AW	Chkd: PO
Date: 27/05/2026	Date: 27/05/2026	Date: 27/05/2026
Scale: A3 - NTS	Status: Proposed	
Drawing No	Rev:	
DTM29204 - 001	-	