

Vehicle Actuated phase timings

Phase 1: Birmingham Road EB	Red	10s	
	Green	40s	
Phase 2: Birmingham Road WB	Red	8s	
	Green	40s	
Phase 3: John Street	Red	10s	
	Green	40s	

Please note: Timings may only be adjusted by a qualified operative to suit changing traffic conditions if required.

NOTE
Minimum 3m running lane to be maintained at all times.

NOTE
Bus stop to be suspended
Stop ID: nwmpdga.

NOTE
Pedestrians to use existing dropped kerbs.

- KEY**
- Pedestrian Barrier
 - Cone
 - Sign
 - Portable traffic signal
 - Closed area
 - Traffic signal phase
 - Diversion route
 - Closed area
- WORKS ACCESS WORKS EXIT**
- Works access/ works exit to be risk assessed on site for suitability of location

DETAIL B

Single/Dual carriageway 40mph or less - 1m traffic cones, spacing 1.5m.
Single/Dual carriageway 50mph or more - 1m traffic cones, spacing 1.5m.
Dual carriageway national speed limit - 1m traffic cones, spacing 1.5m, relaxation 3m.

Notes:
1) During darkness, warning lights to BS EN 12352:2006 should be provided in accordance with Table A1.3 (Appendix 1).
2) 45° tapered bases 1.5m spacing, no relaxations.
3) On motorways and NSL AP ducts with hard shoulders, 1m cones will be required for both standard and relaxation works for lead tapers and the facing wall of lane changes.

DETAIL C2

Single carriageway 40mph or less - 1m traffic cones.
Single/Dual carriageway 50mph or more - 1m traffic cones.

Notes:
1) During darkness, warning lights to BS EN 12352:2006 should be provided in accordance with Table A1.3.

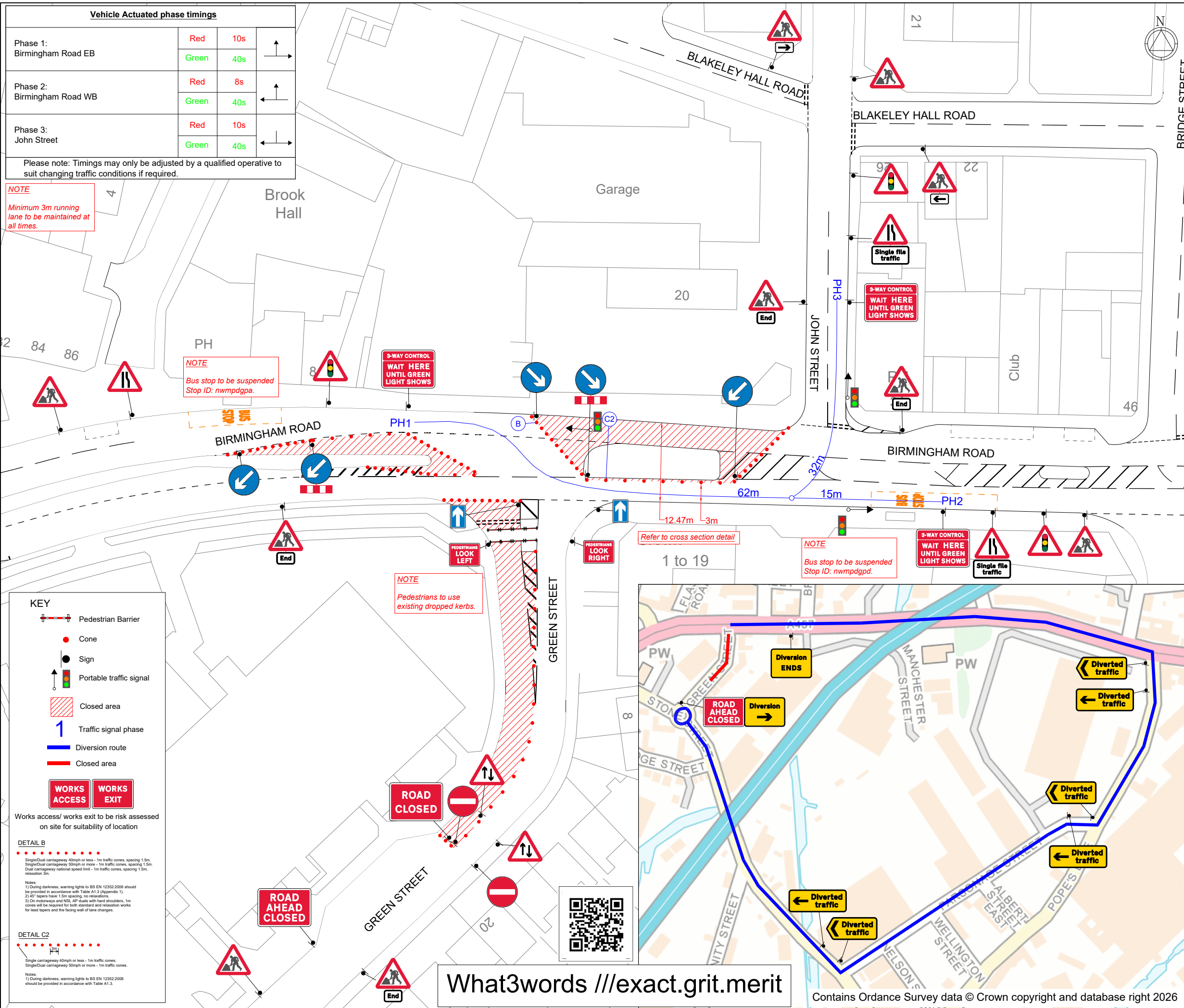

KIT LIST

Qty: 1 Ref: 2702 Start of temporary diversion route	
Qty: 1 Ref: 2702 End of temporary diversion route	
Qty: 3 Ref: 2703 Direction of temporary diversion route from junction ahead	
Qty: 3 Ref: 2704 Direction of temporary diversion route	
Qty: 3 Ref: 517 Road narrow in one side only ahead - right	
Qty: 2 Ref: 518 Road narrow	
Qty: 2 Ref: 521 Road works	
Qty: 2 Ref: 545 Traffic signs ahead	
Qty: 1 Ref: 523 Direction of travel sign	
Qty: 1 Ref: 525 Direction of travel sign	
Qty: 2 Ref: 610 Roundabout	
Qty: 2 Ref: 610 Roundabout	
Qty: 1 Ref: 640 End	
Qty: 2 Ref: 660 End	
Qty: 1 Ref: 660 End	
Qty: 10 Ref: 1001 Road works ahead	
Qty: 1 Ref: 700/PP-1/3-9 Road Ahead Closed	
Qty: 2 Ref: 700/PP-1/3-9 Road Ahead Closed	
Qty: 3 Ref: 701.1 3-Way Control - Wait here until green light shows	
Qty: 1 Ref: 1011 Look Left	
Qty: 1 Ref: 1012 Look Right	
Qty: 2 Ref: 710 Level crossing	

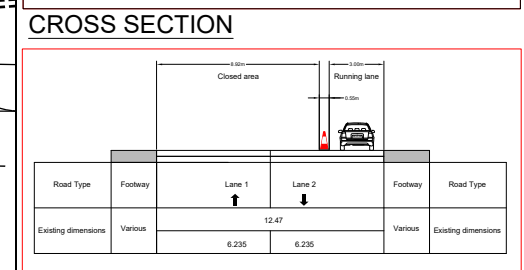

Rev	Description	By	Chkd	Date
Revisions				

Client
nationalgrid

Project
Birmingham Road,
Oldbury B69 4JP
Grid Ref: 399348 , 289391

Title
Temporary Portable
3 Way Traffic Signals
& Road Closure
and Diversion



Design: DW	Drawn: SJC	Chkd: LG
Date: 20/05/26	Date: 20/05/26	Date: 20/05/26
Scale: NTS @ A3	Status: PROPOSED	
Drawing No 50581.001		Rev:

What3words ///exact.grit.merit