

**SITE LENGTH 20M**

**TMO TO ALLOW ACCESS WHEN POSSIBLE FOR RESIDENTS**

|                  |               |                               |
|------------------|---------------|-------------------------------|
| Contract No      | 254-S016320   | Client: <b>OPENREACH</b>      |
| Date             | 22/01/2026    | Site Location / Drawing Title |
| Drawn by         | RS/878        | 21 BROOKLANDS WALSALL         |
| Approved By      | JW/254        | WS5 4DJ                       |
| Purpose of works | TELECOM WORKS |                               |
| Version Number   | 01            |                               |
| Amended By       | xxxxxxxxx     |                               |
| Amendment Date   | xx/xx/xxxx    | Scale                         |
| Sheet No         | 1 of 1        | OS Licence No                 |
|                  |               | NOT TO SCALE                  |
|                  |               | 000000000000                  |

**Note**  
 1. All equipment shall be approved and shall comply with the Department Of Transport specification MCE0111. This drawing does not show the normal road works signage that will be required as per Chapter 8.  
 2. All signs to be in accordance with TSGRD 2002 and to minimum class retroreflective.  
 3. Minimum height of lettering to be 60mm and sign boards to be 1000mm (750mm where appropriate).

The information in this drawing may not be copied or used by third parties without written consent from Sunbelt Rentals Ltd (Traffic Management). This layout is for installation by NRSWA, Lantra 12A,12B,12C,12D qualified persons. All works shall be in accordance with Safety at Street Works and Road Works, A Code of Practice 2013 & Chapter 8

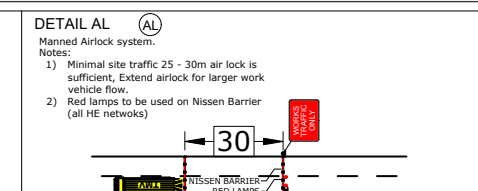
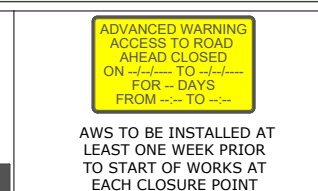

**THIS DOCUMENT IS UNCONTROLLED WHEN PRINTED**

The electronic version of this document is the approved and most current. Any printed version is uncontrolled and may not be current.

**SUNBELT RENTALS**

Sunbelt Rentals UK (Traffic Management)  
 Kemble Airfield Enterprise Park, Cirencester Road,  
 Kemble GL7 6BQ  
 Telephone: 0370 050 0792