

Traffic Light Phase Timings			
Phase 1: Tivdale Road, (W)	Red	20s	
	Green	45s	
Phase 2: Tivdale Road, (E)	Red	20s	
	Green	45s	
Note: Timings may only be adjusted by a competent operative to suit traffic conditions if required			

TRAFFIC LIGHT TIMINGS TO BE REVISED WHEN TRAFFIC LIGHT SET UP IS REDUCED

SEE DTM 8110-003 FOR ROAD CLOSURE AND DIVERISON ROUTE DETAIL

SEE DTM 8110-003 FOR ROAD CLOSURE AND DIVERISON ROUTE DETAIL

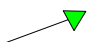
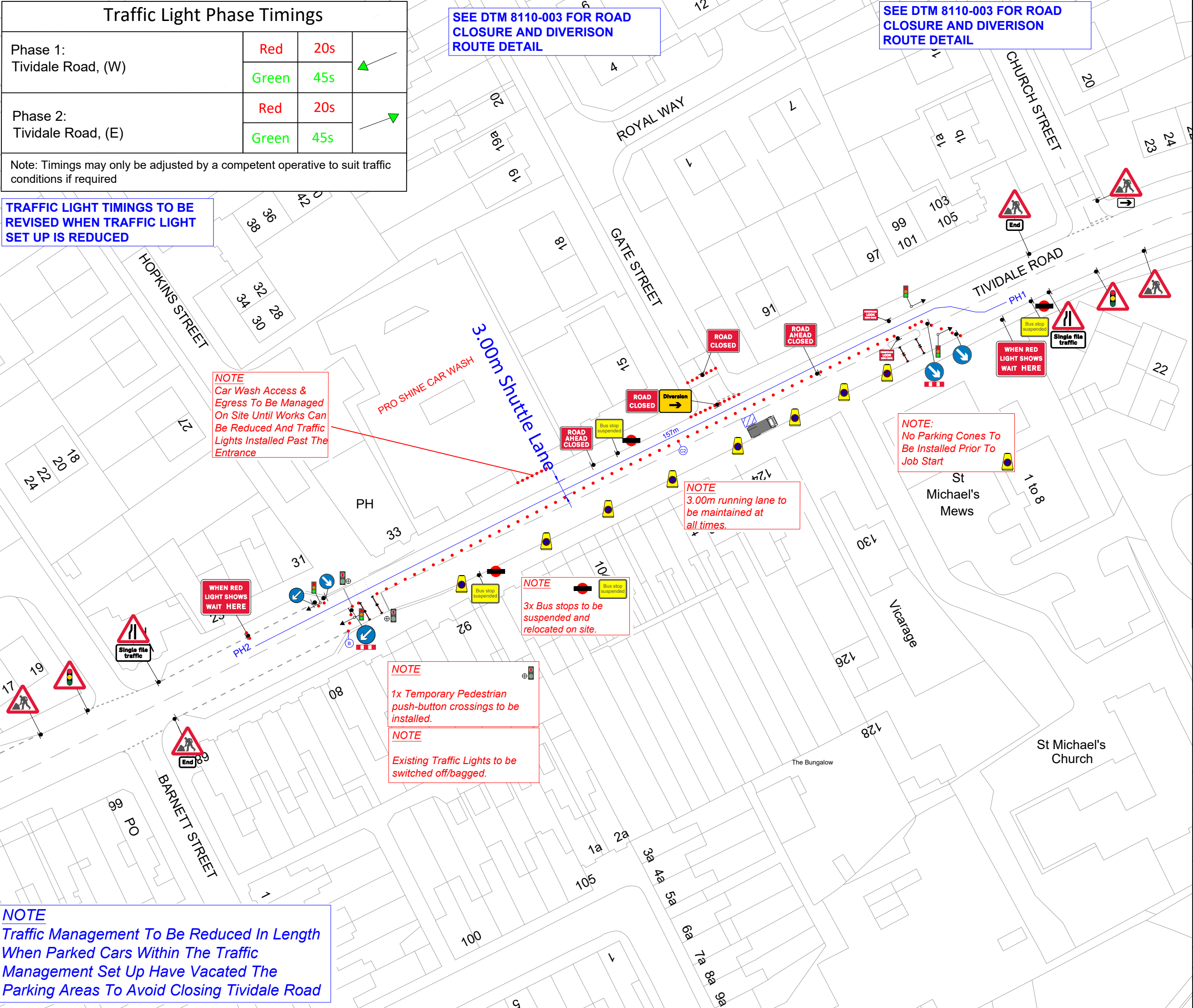

- KEY
- Cone
 - Sign
 - Work area
 - Traffic light head
 - Traffic light phase
 - Pedestrian light head

DETAIL B

Single/Dual carriageway 40mph or less - 450mm traffic cones, spacing 1.5m.
Single/Dual carriageway 50mph or more - 750mm traffic cones, spacing 1.5m.
Dual carriageway national speed limit - 750mm traffic cones, spacing 1.5m, relaxation 3m.

Notes:

- During darkness, warning lights to BS EN 12352:2006 should be provided in accordance with Table A1.3 (Appendix 1).
- 45 degree tapers have 1.5m spacing and no relaxations.
- On motorways and NSL AP duals with hard shoulders, 1m cones will be required for both standard and relaxation works for lead tapers and the facing wall of lane changes.

DETAIL C2

Single carriageway 40mph or less - 450mm traffic cones.
Single/Dual carriageway 50mph or more - 750mm traffic cones.

Notes:

- During darkness, warning lights to BS EN 12352:2006 should be provided in accordance with Table A1.3.

Min width of sideways safety zone (S)	0.5 m
Min length of longways clearance (L)	0.5 m
Speed of the road	

Rev	Description	By	Chk	Date
Revisions				

Client:

Project:

Tivdale Road,
Oldbury, B69 2LG
Grid Ref: (x)396190 ; (y)290759

Title:

Temporary Two Way
Traffic Lights & Pedestrian
Crossing & Road Closure And
Diversion



Design: ACW	Drawn: ACW	Chkd: OP
Date: 15/12/25	Date: 15/12/25	Date: 15/12/25
Scale: A3 - NTS	Status: Proposed	
Drawing No		Rev:
DTM8110 - 002		-