

Safety Zones:

Longways-0.5m  
Sideways-0.5m



ROAD CLOSURE :

NOTES

- 1. All traffic signs shall comply with Chapter 8 of the Traffic Signs Manual
- 2. All traffic signs shall be positioned so as not to be obscured by any other objects or shall not be obscured by any other signs, permanent or temporary, as much as is reasonably practicable.
- 3. All signs shall be positioned so as not to be obscured by any other objects or shall not be obscured by any other signs, permanent or temporary, as much as is reasonably practicable.
- 4. All traffic signs shall meet the reflectivity requirements of BS 6753 - Part 6 : 1993, Table 1.
- 5. Work Access Signs to be positioned to suit ongoing works.

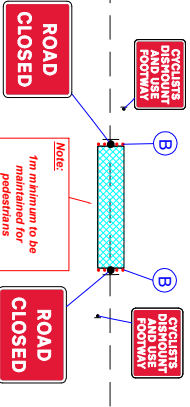

Written diversion route:

Tudor Rd, Matty Rd, Defford Dr,

Qty: 1 Ref: 13-9-RCAO Road Closed Access Only	ROAD CLOSED ACCESS ONLY
Qty: 1 Ref: 2702 Start of temporary diversion route	Diversion
Qty: 2 Ref: 2702 Start of temporary diversion route	Diversion
Qty: 2 Ref: 2702 End of temporary diversion route	Diversion ENDS
Qty: 2 Ref: 2703 Direction of temporary diversion route from junction ahead	Diverted traffic
Qty: 1 Ref: 2703 Direction of temporary diversion route from junction ahead	Diverted traffic
Qty: 2 Ref: 573 Direction to hazard left	Diversion
Qty: 2 Ref: 573 Direction to hazard right	Diversion
Qty: 1 Ref: 612 No right turn	No right turn
Qty: 1 Ref: 613 No left turn	No left turn
Qty: 4 Ref: 7001 Road works ahead	ROAD WORKS AHEAD
Qty: 2 Ref: 7010-PP-13-9 Nature of temporary hazard ahead - Road Closed	ROAD CLOSED
Qty: 3 Ref: 7010-PP-13-9 Nature of temporary hazard ahead - Road Ahead Closed	ROAD AHEAD CLOSED

Road Closure

Barnfordhill Cl,  
Oldbury  
B68 8ES

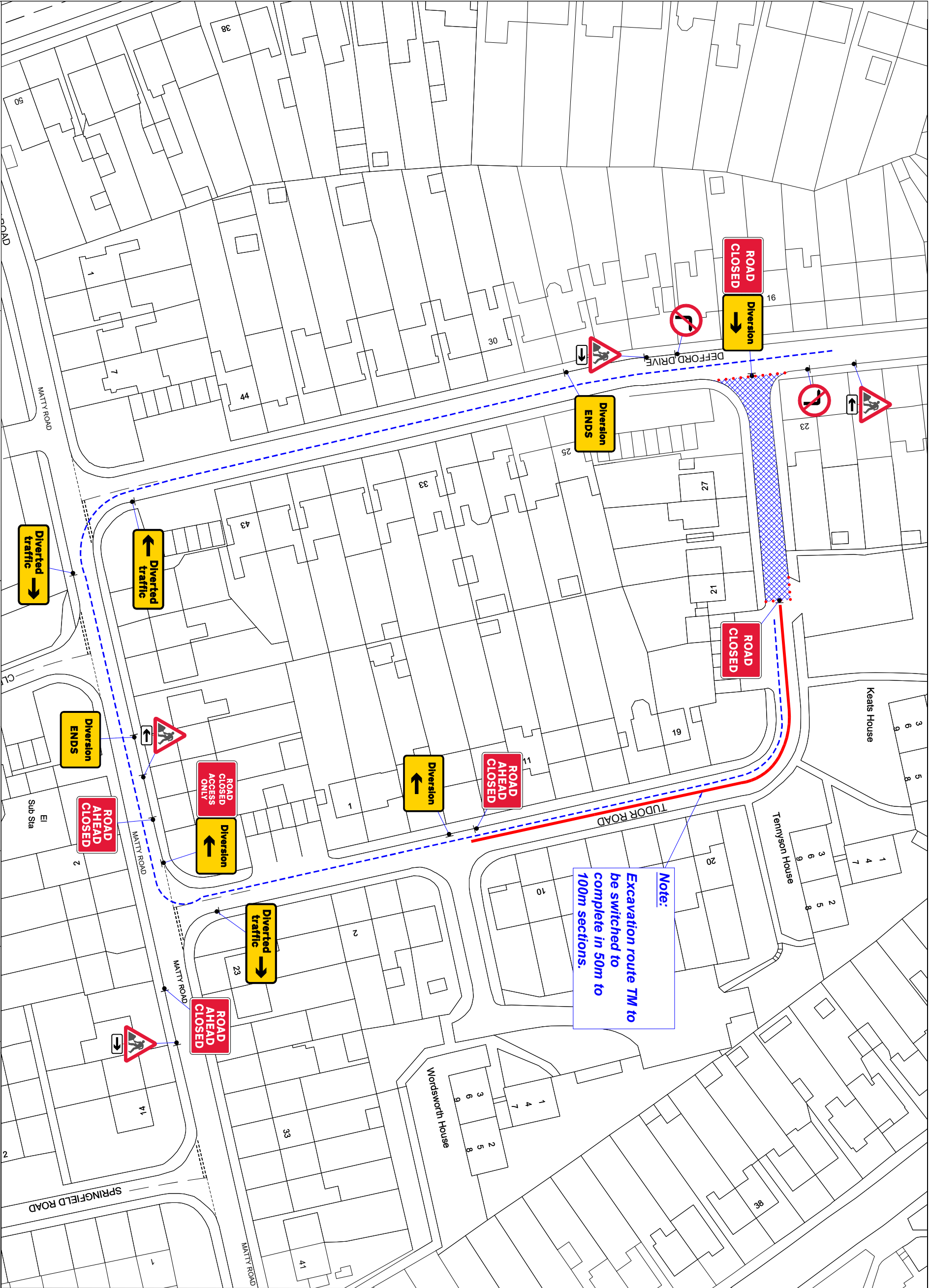

NOTES:

- 1. All signs and cones to be in accordance with Chapter 8 new roads and street works a code of practice (Red book)
- 2. Works access and egress are indicative, exadlocations to be agreed on site.
- 3. Safety zones are to be installed as required as shown by the SAFETY ZONE DIMENSIONS

- BELOW
- 4. All signs to be located so as not to obscure signs or objects and should be ballasted near to ground level using sand filled hessian bags or sign straps.
- 5. All sign positions are indicative only and must be accurately positioned on site with good visibility and be clear of and obstructions or vegetation at all times.
- 6. Drawing not to scale

Cadent

Your Gas Network

Sapphire

Utility Solutions

cadrequest@sus.co.uk

tmbookings@sus.co.uk

Drawn By: P.Ndlovu

Drawing No: WMGA240379.22

Approved: JD

Date: 23/05/2025

Scale: NTS

Traffic Management Type:

STREET ADDRESS:

WORKS ACCESS

WORKS EXIT

Traffic sign

Cone

Diversion

Ramp

Work Area

Safety Zone

MH Location

Road Closure

Barnfordhill Cl,  
Oldbury  
B68 8ES